

6E 7602.b

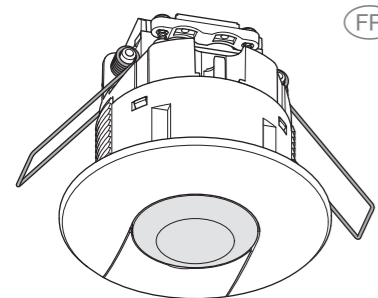

EE815

Description

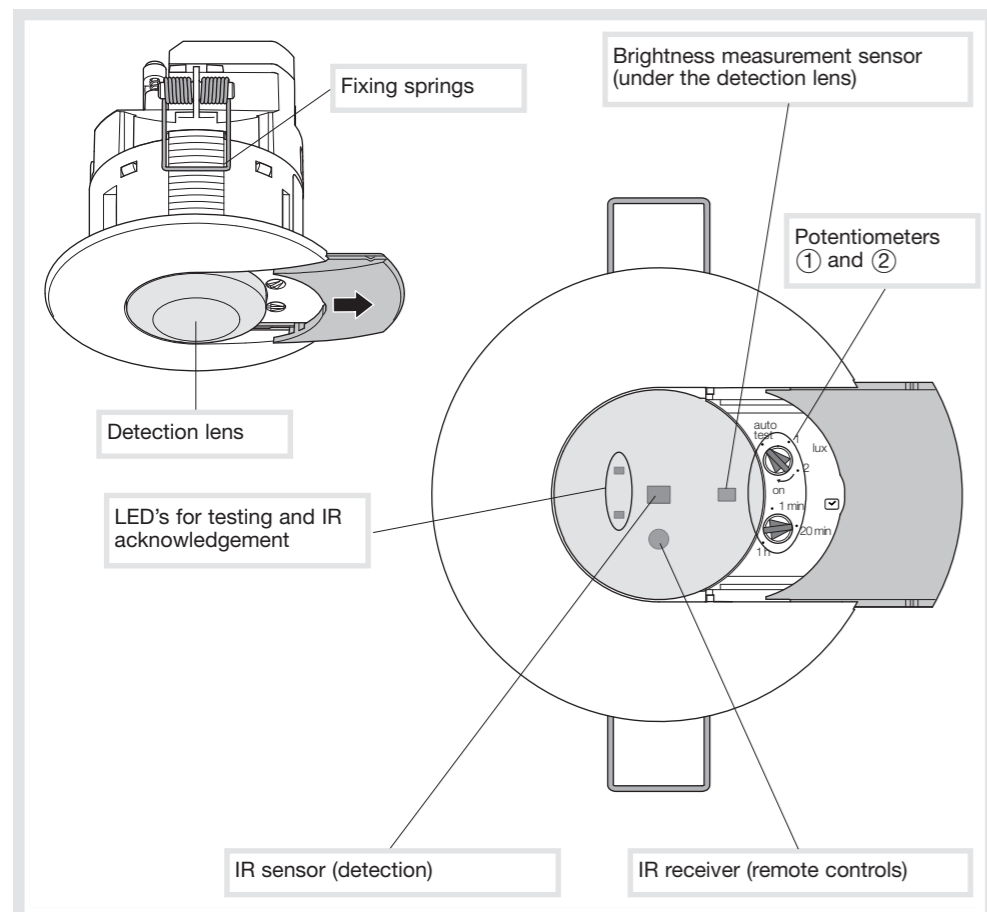

Detection areas

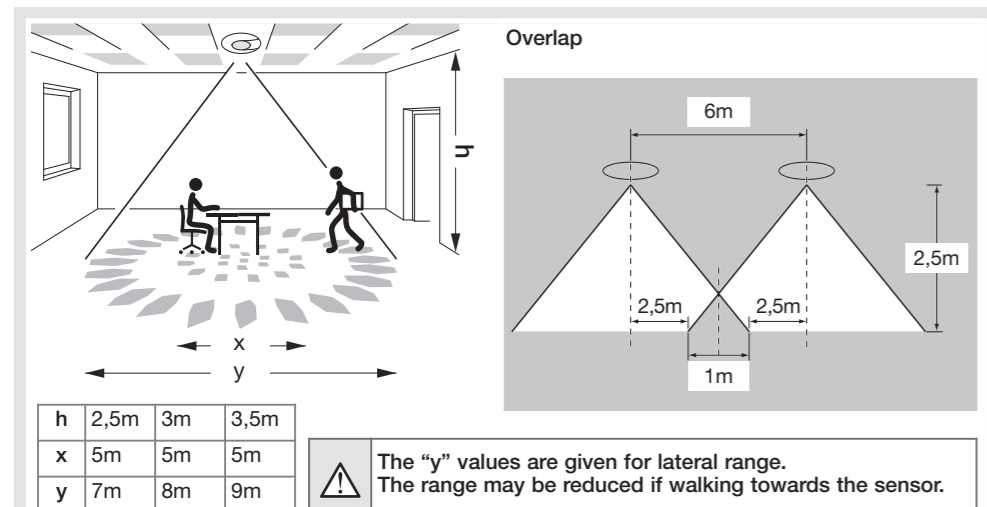

Settings

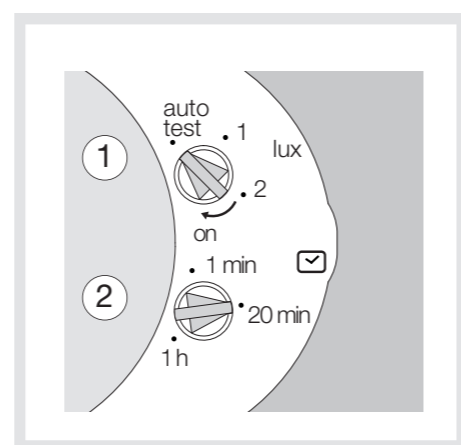

Instances of lighting levels

Position of potentiometer	Lux value approximate *	Application
auto test	preset	
1	200	Corridor
>1 ... 2 <	> 200 ... 400 <	
2	400	Offices
>2 ... On <	> 400 ... 1000 <	
On	1000	Offices

* The light measurement accuracy (Lux) is affected by the environment (furniture, ground, walls...). If necessary, the level has to be adjusted by potentiometer or remote control.

Remote control for settings

- The installer remote control EE807 can be used to set the following features if the potentiometer is set on "auto test":
- Lux levels (☼ ☹ ☺ ☻ ☼ ☹ ☺ ☻)
 - Time (⌚)
 - Absence/presence detection (🏠)
 - Power up behaviour (⚡☼)
 - Active/passive cell (☼☹☼)

Override remote control

The remote control EE808 allows the switching ON or OFF of the light (on off). The EE808 allows the same functionality as the wallswitch.

Caution:

This device must be installed by a suitably qualified electrician according to the installation's standards.

Product description and operating principles

Occupancy sensor EE815 is designed to detect low level movements (e.g. person sitting at a desk). Detection is by means of a pyro-electric sensor located under the detection lens.

The occupancy sensor measures the brightness in the room on a continuous basis and compares it to the level preset on the potentiometer (or by means of the remote control EE807).

Settings

The Lux threshold and time out period can be set with the potentiometers or by using the installer remote control (EE807).

Test Mode

This mode makes it possible to validate the detection area. To select this mode, set the potentiometer ① to the position "auto test". The green or red LED behind the lens is on for 2 seconds after detection. The red LED indicates that the light level measured is lower than current setting. If the green LED is on, the light level measured is higher than current setting. There is a time out of 2 minutes which is reactivated after each detection. The output is also switched during 2s. after each detection. It is also possible to use the remote control EE807 to set the detector in test mode.

Functional modes

The detector has 2 different modes:

- automatic (presence).
- semi-automatic (absence)

The power up and cell operation can be set for each mode.

A pushbutton connected to the product makes it possible to reverse the lighting output state. This state is maintained for the time period set by the potentiometer ② or the remote control EE807.

Automatic mode (presence detection)

In this mode the light is controlled by motion in the detection area and ambient light levels. If presence is detected whilst the light levels are below the required Lux level, the sensor is activated and keeps the light on whilst there is still occupancy and for the time out period afterwards. Once the sensor has deactivated the lights, it will require a new occupancy whilst the ambient light levels are below the required Lux levels to activate the lights again.

This mode can be changed via the IR remote control EE807 (default mode is presence detection: automatic).

Semi automatic mode (absence detection)

The sensor needs to be activated by a pushbutton or a user remote control input. Once the sensor is activated, it will hold the lights on whilst there is still occupancy and for the time out period afterwards. Once the sensor has deactivated the lights, it will require another input from the wallswitch or the remote control to switch the lights on.

Power Up

A parameter of the detector allows the choice of state for the lighting after power up (mains return). During warm up phase, the green LED blinks. In the Power up ON state the lighting will automatically be energised when mains power is initially supplied or returned to the sensor. In the Power up OFF state the lighting will not be energised and the sensor will not operate during warm up period. This parameter is modified using the installer remote control EE807.

POWER UP state:

- ON: The light is immediately switched on for 30s after power up. In case of detection, the light (in automatic mode) remains on during the time delay; otherwise the light is switched off.
- OFF: The detector switches to the selected mode after warm up.

Active/passive cell

Active cell

The photocell will inhibit the output from the sensor if the ambient light level is sufficient. If the sensor detects occupancy whilst the ambient light level is below the required Lux level, the lights will be activated. However if the ambient light level increases to a value where it is above the required Lux level during a certain time, the sensor will detect it and switch off the light.

Passive cell

The photocell will inhibit the output from the sensor if at the time of detection the ambient light level is sufficient. However if the ambient light level increases, the photocell will not turn off the light.

Factory settings	
Luminosity threshold	400 lux
Lighting time	20 min.
Mode	Presence
Power Up	OFF
Active cell (Luminosity Cell)	ON

Technical features

Electrical characteristics
Supply voltage: 230 V ~ +10% -15% 50-60 Hz
Consumption with no load: 2,4 VA/270 mW

Functional characteristics
Lighting output operating time: 1min. → 1h
Brightness level: 5 → 1000 Lux
Recommended installation height: 2,5 → 3,5m
Detection range: Ø 7m (installed product height: 2.5m)
Products can be connected in parallel.
Hole size required: 60mm

Environment
Operating temperature: -10 °C → +45 °C
Storage temperature: -20 °C → +60 °C
Class of insulation: II
IK 03
Index of protection: IP41
Fire resistance: 650°C
Standards: IEC 60669-1, IEC 60669-2-1



Connection capacity
0.5mm² to 1.5mm² flexible,
0.5mm² to 1.5mm² rigid

Action	Settings	Potentiometer
Use Auto settings (factory) or set by the remote control to switch the light automatically for a defined time.	Auto Settings Put the Lux potentiometer on "auto test". The settings are predefined: Lux = 400, time = 20 minutes, ⚠: test mode for 2 minutes.	
Automatically switch on the light for a defined time.	Remote control settings EE807 (manual settings inhibited). 	
Test and validate the detection zone.	Installer settings Test mode Move the potentiometer ① to "auto test". On this position, the remote control EE807 can be used.	